



# CEMBRE

**DB/1N DBLOCK** POWER DISTRIBUTION BLOCKS  
NEW UNIPOLAR SERIES UL CERTIFIED



[www.cembreinc.com](http://www.cembreinc.com)

# DB/1N DBLOCK / NEW UNIPOLAR SERIES UL CERTIFIED

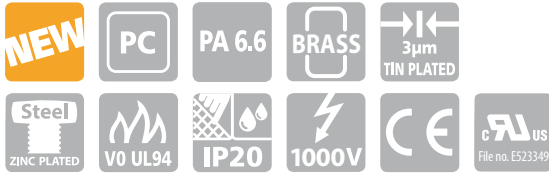

- 80, 125, 160, 250, 400, 500 A distribution blocks
- Versions available with 6, 7 or 11 outputs (see table)
- Wire entry facilitated by chamfered entry holes and clamping screws
- Terminals maintain excellent stability of the connection over time

Type	N° inputs	Connecting Capacity in AWG	N° outputs	Connecting Capacity out AWG	IEC* 60947-7-1		UL* 1059		Allowable short duration fault current (Icw)	Maximum allowed peak fault current (Ipk)	Self Extinguishing Specification	Dimensions in.	Weight lbs	Quantity
					Nominal voltage	Nominal Current	Nominal voltage	Nominal Current						
DB80-6/1N	1	16 - 4	6 (4+2)	(4) 16 - 8 (2) 16 - 4	1000 V	80 A	600 V	85 A	3 kA	22 kA	V-0 (UL 94)	2.6 x 1.0 x h1.8	0.15	5
DB125-7/1N	1	8 - 1/0	7 (6+1)	(6) 14 - 4 (1) 14 - 2	1000 V	125 A	600 V	150 A	4.2 kA	30 kA	V-0 (UL 94)	3.0 x 1.1 x h1.8	0.31	5
DB160-7/1N	1	8 - 3/0	7 (6+1)	(6) 14 - 4 (1) 14 - 2	1000 V	160 A	600 V	200 A	11.8 kA	30 kA	V-0 (UL 94)	3.0 x 1.1 x h1.8	0.30	5
DB250-11/1N	1	6 - 250MCM	11 (2+5+4)	(2) 10 - 1 (5) 14 - 4 (4) 14 - 6	1000 V	250 A	600 V	255 A	24.5 kA	51 kA	V-0 (UL 94)	3.8 x 1.8 x h2.0	0.93	3
DB400-11/1N	1	3/0 - 400MCM	11 (2+5+4)	(2) 10 - 1 (5) 14 - 4 (4) 14 - 6	1000 V	400 A	600 V	335 A	24.5 kA	51 kA	V-0 (UL 94)	3.8 x 1.8 x h2.0	0.88	3
DB500-11/1N	1	max 8x24 mm Flex. Busbar	11 (2+5+4)	(2) 10 ÷ 1 (5) 14 ÷ 4 (4) 14 ÷ 6	1000 V	500 A	600 V	335 A	24.5 kA	51 kA	V-0 (UL 94)	3.8 x 1.8 x h2.0	0.85	3



## Cembre Inc.

Raritan Center Business Park  
300 Columbus Circle-S.F.,  
Edison, NJ 08837 USA

Ph (732) 225-7415  
Fax (732) 225-7414  
sales.us@cembre.com

## Midwest Office

1051 Perimeter Dr #610  
Schaumburg, IL 60173

- Connection can be expanded through dedicated unipolar jumpers (can be used for types DB125-7/1N and DB160-7/1N)

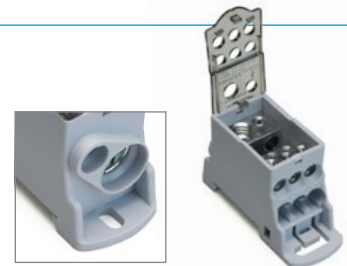

www.cembreinc.com



6260944