

PROFILE

OVERVIEW

MB Kit Systems continues to push industry boundaries by creating the most advanced mechanical extruded aluminum solutions in a wide-range of applications. The forefront for the complex solutions designed and built is the high-quality, expansive profile lines used for each project. Profile line size and weight variances enable designs to maximize efficiency, while keeping cost low by utilizing the appropriate profile selection. Each project is specifically engineered to meet exact specifications at no-cost to the customer.

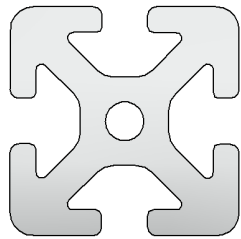

L8

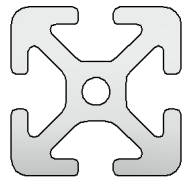

L6



L5

STANDARD



S

Strongest
Heavy-duty
Light

LIGHT

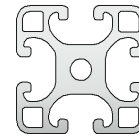

L

Stronger
Most popular
Lighter

ECONOMY

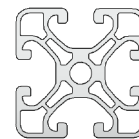

E

Strong
Light-duty
Lightest



LINEAR MOTION



MATERIAL HANDLING



SAFETY HARD GUARDING



MACHINE STRUCTURES



ENCLOSURES



WORKSTATIONS

BENEFITS

The foundation for aluminum profile is the extruded T-slot groove and aluminum alloy's light-weight make-up. T-slot and fastener technology allow for high straightness tolerances and joints to be as strong as welded steel. The groove flank inclination is a design feature that ensures stable and anti-vibration connections when securing all profile, accessories and other components. Project modifications, configurations and additions are quick and easy. Modular design principles are incorporated for complex application builds.

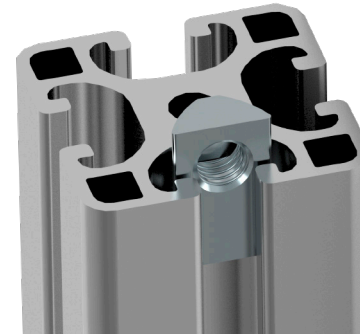

T-SLOT



STANDARD

Used for fixed positioned profile applications. Lowest-cost fastener option. An anti-torsion tab is on each end to prevent displacement. A one-sided option is available that is beneficial when placing panels in groove so cutouts are not required and when making caps flush to profile on guarding and doors.



AUTOMATIC

Enables profile application to be modular. No machining required—used in pairs. Automatic fasteners are screwed into the profile from one end. A screw then slides through the fastener and is secured with a T-slot nut. Caps are included to cover the fastener.

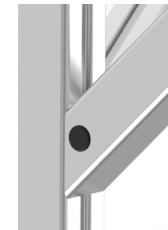

MITER

Profile connections from any angle. The T-slot profile groove remains open for other elements.

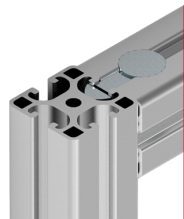

UNIVERSAL

Easily placed in machined profile or can be added to pre-existing assemblies. Anti-torsion tabs minimize deflection/rotation. Provides adjustability when needed. Machined/used in pairs (both sides) or one per side at opposite ends.

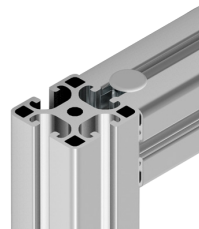

CENTRAL

Used for applications with minimal loads. Provides clean finish to project. Similar to universal fasteners, but only one is required per end. Allows three other grooves to be accessed when fastened is beneficial when placing panels or mounting a component. Requires extensive profile machining.



BRACKETS

Requires no profile machining. Reinforces profile connections.

STRONG • LIGHT • MODULAR

PROFILE | L5

OVERVIEW: L5 is the smallest profile line option offered. Best used for the smallest-sized applications. Despite the dimensional profile of L5 being considerably smaller in size than L8, it is still a very structurally sound material. This line is often used in situations where high loads are not applicable. It is commonly used in conjunction with other profiles to save material cost, while meeting specified project requirements. Available with open and closed grooves for a more attractive appearance.

BEST USES: Often used in conjunction with other profile lines. Small enclosures, low-load requirements, and support beams.

L5

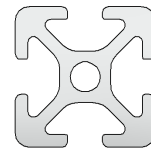

20x20



40x20



40x40



60x20



L5N

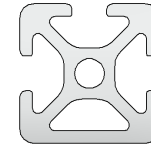

1N

20x20



2N90

20x20



2N

40x20



3N

20x20



L5R



R20-90°

L5F



20x10

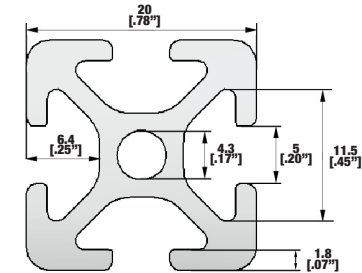

GUIDE

L5  L6 

 **S** = STANDARD

// ALL SIZES IN METRIC //

 **L** = LIGHT

 **E** = ECONOMY

MBKIT.COM

888.729.4500







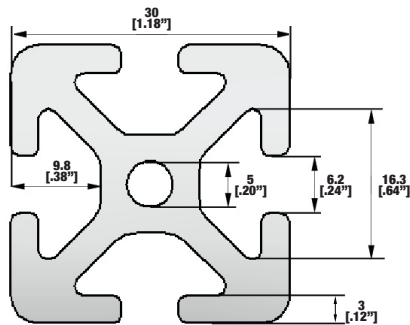

PROFILE | L6

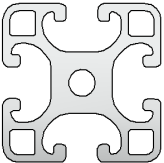
OVERVIEW: Mid-range sized profile line with high structural strength. Profile available in Standard and Light weight options. L6's T-slotted groove is 6mm. Included in designs where specifications require a light, yet strong structure. While there are fewer options available in this size, it is a very functional line to use for the correct application

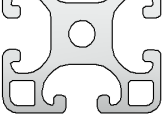







BEST USES: For crowded and compact spaces. Lightweight guarding, small enclosures and structures are common uses for this line.

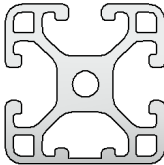

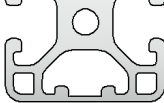
L6

	30x30	S,L	
	60x30	S,L	
	60x60	S,L	
	120x30	S,L	
	120x60	S,L	

L6A

	1N	30x30	L	
	2N90	30x30	L	
	2N180	30x30	L	
	3N	30x30	L	

	R20-90°	L
---	---------	---

L6R

	R30-90°	L
---	---------	---



PROFILE | L8

OVERVIEW: L8 is the base design for all t-slotted extruded aluminum designs. Being robust and strong it is the most popular line of aluminum profile because the high-volume of compatible components and accessories, making L8 profiles suitable for most applications. The three profile line variants and various sizes are included with many of L8's profile variations. Satisfy virtually all of your construction needs using L8 by configuring or adding components into the 8mm groove such as polycarbonate panels to wire mesh.

BEST USES: All solutions can be built with L8 due to the wide-array of profile designs, components and structural strength.

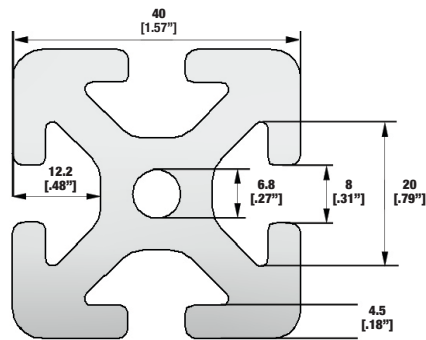

L8

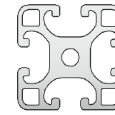

40x40	S,L,E	
80x40	S,L,E	
80x80	S,L,E	
w80x80x40	L	
120x40	S,L,E	
120x80	S,L	
160x28	S	
160x40	S,L	
160x80	S,L	
160x160	S	
200x28	S	
200x40	S	

L8N

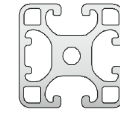

1N	40x40	L	
	80x40	L	
2N	80x40	L	
	80x80	L	
2N90	40x40	L	
2N180	40x40	L,E	
	80x40	E	
3N	40x40	L	
3N90	80x40	E	
4N	40x40	L	
	160x40	L	
4N90	80x80	L	
4N180	80x40	E	
6N	80x40	L	

GUIDE



S = STANDARD

L = LIGHT

E = ECONOMY

// ALL SIZES IN METRIC //

MBKIT.COM

888.729.4500



FRAME PROFILE



L8A



CLAMP PROFILE



BED PLATE



L8F



GRIP RAIL



L8R



CONDUIT

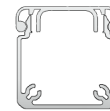

ROLLER PROFILE

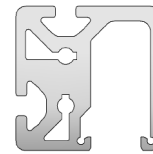

R40-80

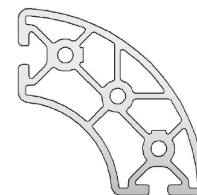

CASTOR RAIL

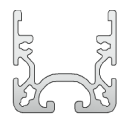

LX



TUBE D30-50



COVER PROFILE



X-XMS

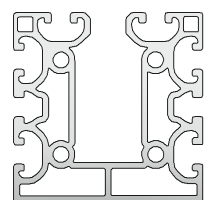

VISIT
MBKIT.COM/PROFILE
TO SEE ALL PROFILES

PLAN DESIGN BUILD



MBKIT.COM

info@MBKit.com

P 330.945.4500

T 888.729.4500

F 330.945.6440

**925 Glaser Parkway
Akron, Ohio 44306**